

BATTERY HOLDERS		5-12
	IP67 Sealed 7 Panel Mounting 8-9 PCB/Base Mounting 10-11	
HAZARDOUS AREA CONNECTORS		13-18
	EXPlora - Zone 2 and 22 13-18	
IP68 SEALED CIRCULAR CONNECTORS FOR POWER		19-44
	900 Series Buccaneer 20-25 Standard Buccaneer 26-34 Mini Buccaneer 35-38 400 Series Buccaneer 39-44	
IP68 SEALED CIRCULAR CONNECTORS FOR DATA		45-72
	Ethernet Buccaneer 46-51 USB Buccaneer 52-57 Mini USB Buccaneer 58-62 FireWire Buccaneer 63-66 SMB Buccaneer 67-69 Wireless Buccaneer 70-72	
IEC CONNECTORS EN60 320 CONNECTORS		73-146
	Inlet and Outlet Connectors 73-97 Distribution Units 99-103 Polysnap Connection Modules 105-129 EMI Mains Filters 131-145	
FUSEHOLDERS		147-164
	Panel Mounting 147-155 IP68 Panel Mounting 156-157 PC Mounting 158-160 Base Mounting 160-161 In-line 162	
INDICATORS		165-172
	Vandal Resistant LED 166-167 LED Bezel 168-169	
SWITCHES		173-196
	Vandal Resistant 174-187 Push Button 188-195 Voltage Selectors 196	
INDEXES and GENERAL INFORMATION		197-212

BATTERY HOLDERS

EXPLORA

BUCCANEER POWER

BUCCANEER DATA

IEC CONNECTORS

FUSEHOLDERS

INDICATORS

SWITCHES

EXPLORA



ATEX Zone 2 & Zone 22 Hazardous Area approved connectors. **Page: 13-18**

ANTENNA

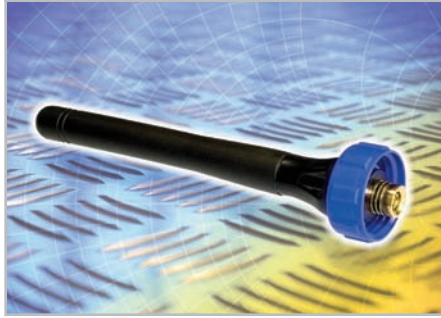

IP68 rated antenna with a 50Ω SMB interface for three frequency bands. **Page: 71**

MINI USB BUCCANEER



IP68 rated mini USB connections with mini 'A', mini 'B' and mini 'AB' interfaces. **Page: 58**

CABLE REPLACEMENT



Waterproof wireless serial data connections using RS232/RS485 to bluetooth adaptors. **Page: 72**

OVERMOULDED CONNECTORS



400 Series & Standard Buccaneer connectors with overmoulded cable preparation. **Pages: 27 & 40**

MPI LOW VOLTAGE



Illuminated vandal resistant switches with integral TVS and LED voltage for 6, 12 & 24V. **Pages: 179 & 180**

MPI SEALED



Illuminated vandal resistant switches with front and rear of panel sealing to IP66. **Page: 181**

FUSEHOLDERS



Two vertically mounted PCB fuseholders for use with 5 x 20mm fuses. **Page: 159**

EXPERTISE

Bulgin, now part of Elektron Technology, has over 80 years experience in the electro-mechanical market and are a major supplier satisfying the most demanding of uses and applications. Customers are able to rely on the stability, quality and range of expertise that this level of experience brings. The company recognises the most prevalent customer demands of quality, reliability and availability of products at a fair price. This 'value' principle continues to be the basis for all business decisions within the company, a major part of which is the ability to control all processes from beginning to end.

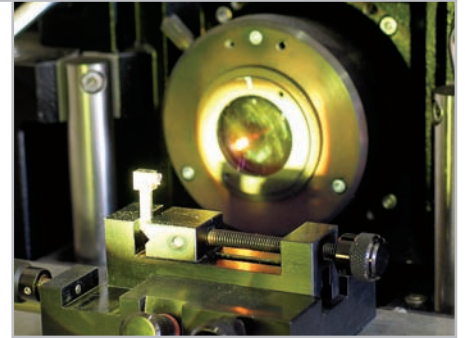
**MANUFACTURE**

The requirement for careful process control has led the company to maintain nearly all its manufacturing 'in-house', with tooling, injection moulding, metal forming and CNC machining all undertaken in our own factories. This vertically integrated philosophy enables the production of over 20 million finished products annually built using semi and fully automated assembly machinery consuming over 80 million mouldings and 200 million piece parts per year. This approach retains control over the entire manufacturing process, from raw materials through to production, inspection and testing.

**DESIGN**

New products are an integral part of Bulgin's brand development and reducing time to market for standard and customer driven requirements is paramount. All new product developments are managed through multidiscipline project teams with the design engineers using the latest 3D CAD modelling systems to ensure that time from concept through rapid prototyping to production is kept to a minimum. This rare degree of flexibility allows a speedy and accurate response to specific customer development requests, both for minor modifications as well as major projects.

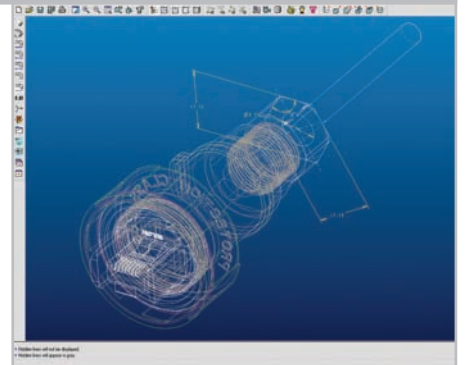
**DISTRIBUTION**

The last link in the chain is the availability of product. Here Elektron Technology is supported by a network of global and local distributors who provide service and support when and where it is needed for Bulgin products.



IT'S QUALITY THAT COUNTS



Certificate No. FM544884
 Certificate No. FM87532

Good design, high quality and maximum value have formed an integral part of the Bulgin philosophy.

We maintain a documented quality plan specifying process and product goals and are approved by BSI to ISO9001:2008.

Investment in new plant and equipment makes an important contribution to continuous quality improvements. The risk of errors in the transition from design to manufacture is greatly reduced by the digital data flows from our CAD system, and our sophisticated automatic manufacturing equipment which can form and assemble components to consistently high quality standards.

Two ISO9001 approvals cover our design and manufacturing sites: certificate FM544884 covers our design procedures, and certificate FM87532 our manufacture processes.

APPROVALS

All new products are extensively pre-production tested, in our dedicated electrical and mechanical test facility, which also conducts regular checks during manufacture.

The numerous international safety approvals gained are testimony in themselves to Bulgin's ongoing commitment to quality and the world wide market place.



ROHS AND WEEE DIRECTIVES

These European Directives introduced environmental responsibilities for electrical and electronics equipment manufacturers. The RoHS (Restriction of use of certain Hazardous Substances) regulation (Directive 2002/95/EC) came into force July 2006. The WEEE (Waste Electrical and Electronic Equipment) regulation (Directive 2002/96/EC), came into force January 2007.

The RoHS directive effectively bans the use of certain chemicals, these are defined as:

- Lead
- Cadmium
- Mercury
- Hexavalent Chromium
- Polybrominated Biphenyl (PBB) - flame retardant
- Polybrominated Diphenyl Ether (PBDE) - flame retardant (including Deca BDE)

Action has been taken to ensure all standard products meet the requirements of this directive. All packing carries RoHS compliance information as conformation.